



Owner's Manual with Installation Instructions

Banks Big Hoss Engine Module

1994-2003 Ford Power Stroke 7.3L Turbo-Diesel

THIS MANUAL IS FOR USE WITH P/N 66505

Gale Banks Engineering
546 Duggan Avenue • Azusa, CA 91702
(626) 969-9600 • Fax (626) 334-1743

Product Information & Sales: (800) 438-7693

bankspower.com



Also Available from Banks Power for '94-03 Ford 7.3L

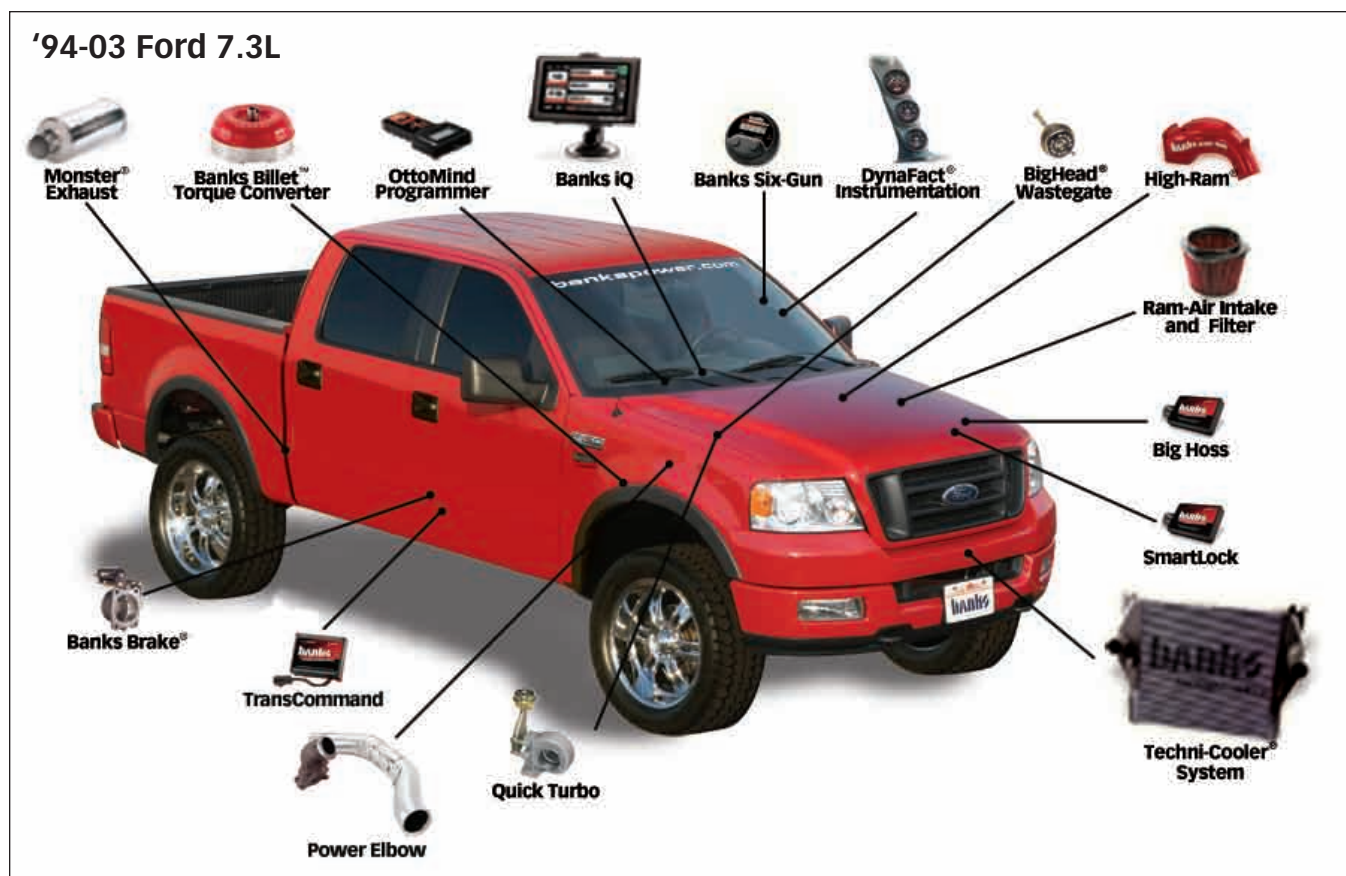

Banks Power Elbow

99-03 (P/N 48651-48652, 48661-48663)

- Reduces stock outlet and pipe backpressure

Banks Monster® Exhaust System

94-97 Single (P/N 46296-46299)

99-03 Sport (P/N 48789)

99-03 Single and Dual (P/N 48653-48660,

47391-47399)

- Increases exhaust flow, cuts backpressure, lowers exhaust gas temperatures (EGTs) and increases power.

Banks Ram-Air Intake System

99-03 (P/N 96885)

- Increases your airflow over stock.
- Adds power, improves fuel economy, lowers EGTs and reduces smoke.

Banks Techni-Cooler® System

94-97 (P/N 25970)

99-03 (P/N 25971-25973)

- Provides increased air flow to the engine by increasing air density for more increased power, lower EGTs and improved fuel economy.

Banks Brake

99-03 (P/N 55202-55207)

- Increases the stopping power of your truck and extends the service life of your brakes

Banks SmartLock

99-03 (P/N 55266)

- Reduces wear on transmission
- Locks Torque Converter and raises transmission line pressure
- Works with Banks Exhaust Brake

Banks Billet Torque Converter

94-03 (P/N 72521)

- Higher torque capacity over stock
- Lockup clutch is slip-resistant so transmission fluids stay cooler and transmission life is prolonged.

Banks Diesel Tuner

99-03 Six-Gun (P/N 66513-66515)

94-03 Big Hoss (P/N 66505)

- Adds power safely to your vehicle
- Engine and transmission safeguards
- Change power levels on-the-fly

Thermocouple

- Add a temperature limiting function to your Diesel Tuner

Banks QuickTurbo

94-97 (P/N 24450)

99-03 (P/N 24456-24457)

- More boost through the powerband
- Does not over-boost
- Turbo-diesel efficiency

OttoMind Programmer

99-03 (P/N 66064)

- Contains Banks tunes that boost your vehicles HP, Torque and MPG.
- Displays a host of critical engine functions
- Provides "service technician" diagnostic capabilities
- Has upgradeable functionality, so it will never be out of date

Banks TransCommand

94-97 (P/N 62560)

99-03 (P/N 62570)

- Produces smooth, firm, light throttle shifts and solid, decisive heavy-load shifts.
- Eliminates excessive clutch slippage

Banks Git-Kit Systems**94-97 (P/N 48550)****99-03 (P/N 47401, 47511-47514)****Contains:**

- Monster Exhaust
- Big Hoss Module

Banks Stinger Systems**94-97 Contains:**

- Ram-Air Intake Filter
- Monster Exhaust
- Big Hoss Module
- TransCommand

99-03 Contains:

- Ram-Air Intake Filter
- Monster Exhaust
- Big Hoss Module
- Big Head Wastegate Actuator

Banks Stinger-Plus Systems**94-97 (P/N 48553-48554, 48559-48560)****Contains:**

- Ram-Air Intake Filter
- Monster Exhaust
- Big Hoss Module
- TransCommand
- Quick Turbo Assembly

Banks PowerPack Systems**94-97 Contains:**

- Ram-Air Intake Filter
- Monster Exhaust
- Big Hoss Module
- TransCommand
- Quick Turbo Assembly
- Techni-Cooler

99-03 Contains:

- Ram-Air Intake Filter
- Monster Exhaust
- Quick-Turbo
- TransCommand
- Techni-Cooler System
- Big Head Wastegate Actuator

Banks Six-Gun Bundle**99-03 (P/N 46594-46613)****Contains:**

- Ram-Air Intake Filter
- Monster Exhaust
- Six-Gun Tuner
- TransCommand
- Big Head Wastegate Actuator

Banks Big Hoss Bundle**99-03 (P/N 46623-46643)****Contains:**

- Ram-Air Intake Filter
- Monster Exhaust
- Six-Gun Tuner
- TransCommand
- Big Head Wastegate Actuator
- Techni-Cooler System
- Big Hoss Module
- Power Elbow

Banks Power Combo 1**99-03 Contains:**

- Big Hoss Module
- TransCommand
- Big Head Wastegate Actuator

Banks Power Combo 2**99-03 Contains:**

- Six-Gun Tuner
- TransCommand
- Big Head Wastegate Actuator

Banks Power Combo 3**99-03 Contains:**

- Big Hoss Module
- Monster Exhaust

Banks Power Combo 4**99-03 Contains:**

- Big Hoss Module
- TransCommand
- Big Head Wastegate Actuator
- Six-Gun Tuner

**For More Information please call (800) 438-7693
or Visit us online @ www.bankspower.com**

Banks Big Hoss™

ENGINE CALIBRATION MODULE INSTALLATION

1. Disconnect all battery ground cables.

2. Locate the ECU. **1994-1997 models only:** The ECU will be located in a recess in the firewall on the engine side, between the steering column and the left front fender. All that will be visible is an elongated electrical connector and wire loom, surrounded by a retainer plate attached with two nuts. See **Figure 1**. **1999-2003 only:** The ECU will be located under the dash toward the left-hand side of the vehicle. It will be housed in a black plastic box bolted to the side of the vehicle.

3. Loosen the bolt attaching the electrical connector to the ECU on the engine compartment side.

4. 1994-1997 only: Remove the two nuts and retaining plate from against the firewall. Pull the ECU out of the firewall toward the front of the vehicle. It may be necessary to remove the rearmost bolts attaching the flexible inner fender well to the body to provide clearance to remove the ECU. **1999-2003 only:** Loosen the two hex bolts on the rear portion of the black plastic box. Remove the box and ECU from the vehicle together. Pull the ECU out of the plastic box.

5. Pry the plastic cap from the rear of the ECU using a small screwdriver, exposing the printed circuit board edge connector inside. Retain the plastic cap. Loosen and remove the six bolts that hold the case of the ECU together. Open the case of the ECU being careful not to lose the plastic spacer or damage any circuitry inside the ECU.

6. Clean both sides of the connector. First, clean the white grease off with a tissue. Next, scrape the clear silicone type coating from the connector fingers with the abrasive square provided. It is very important to clean both sides of the board in order to have a good connection between the ECU and the Big Hoss module. It is only necessary to clean the connector fingers. Be careful not to damage any circuit traces on the board further inside the ECU.

7. Reassemble the ECU case. Orient the Big Hoss module so that its edges line up with the edges of the ECU case. Place the module over the connector and press firmly to set the connection. DO NOT FORCE the module onto the connector, as damage may result to either the ECU or the module. Place a piece of duct tape over the module, fastening it firmly to the ECU.

8. 1999-2003 only: Using a band saw or hacksaw, cut a portion of the black plastic case away allowing the module to reside in its proper location. See **Figure 2**.

9. Replace the ECU in its original location and tighten all bolts. Reattach the ECU connector to the ECU and reattach battery cables.

10. Check the operation of the Big Hoss module and ECU. The vehicle may not start if the coating on the ECU connector is not completely removed or if there is a mismatch of codes. A quick indication of module connections that are not cleaned properly is the "Wait to Start" indicator will fail to light and the "Check Engine" warning indicator will stay lit after the key is switched on. If the engine fails to start, re-clean the ECU connector, reinstall the module and try again.

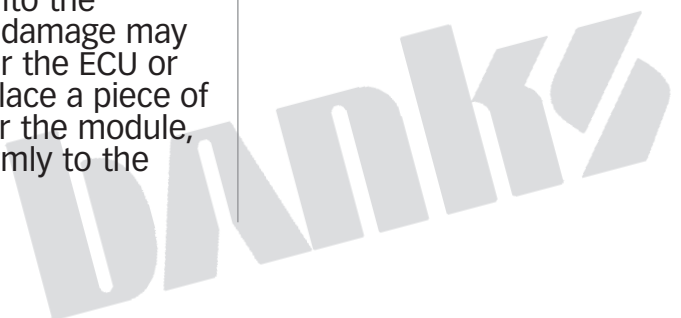

Figure 1

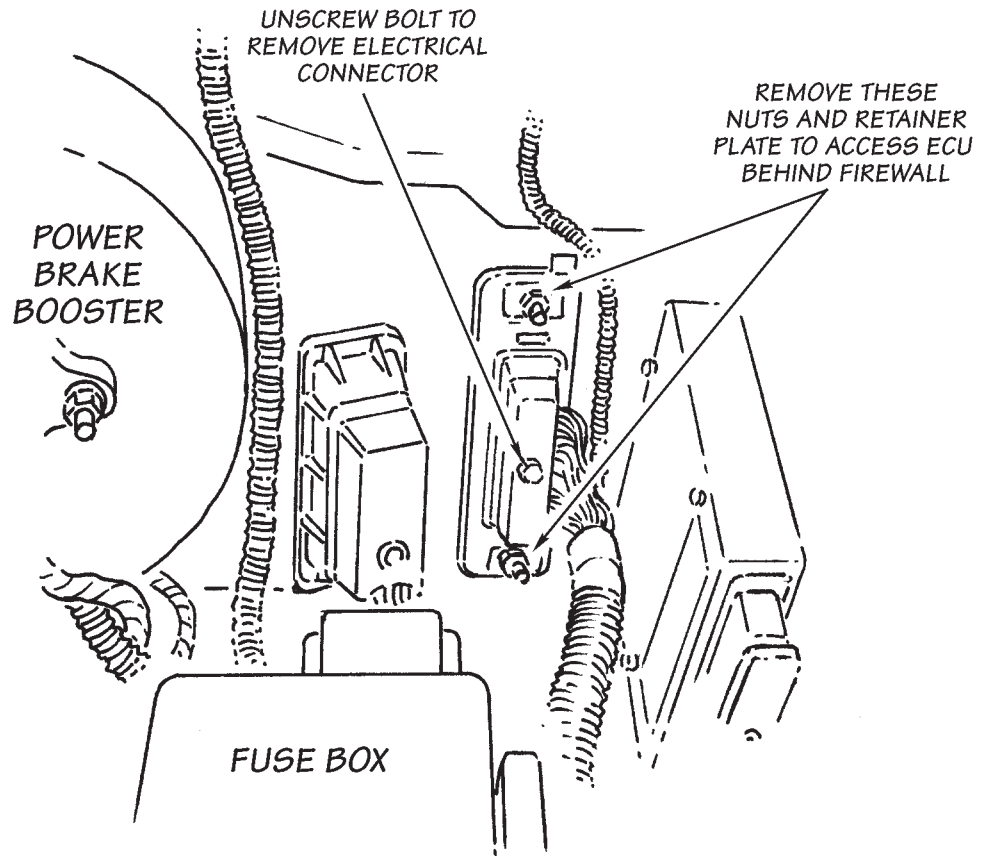
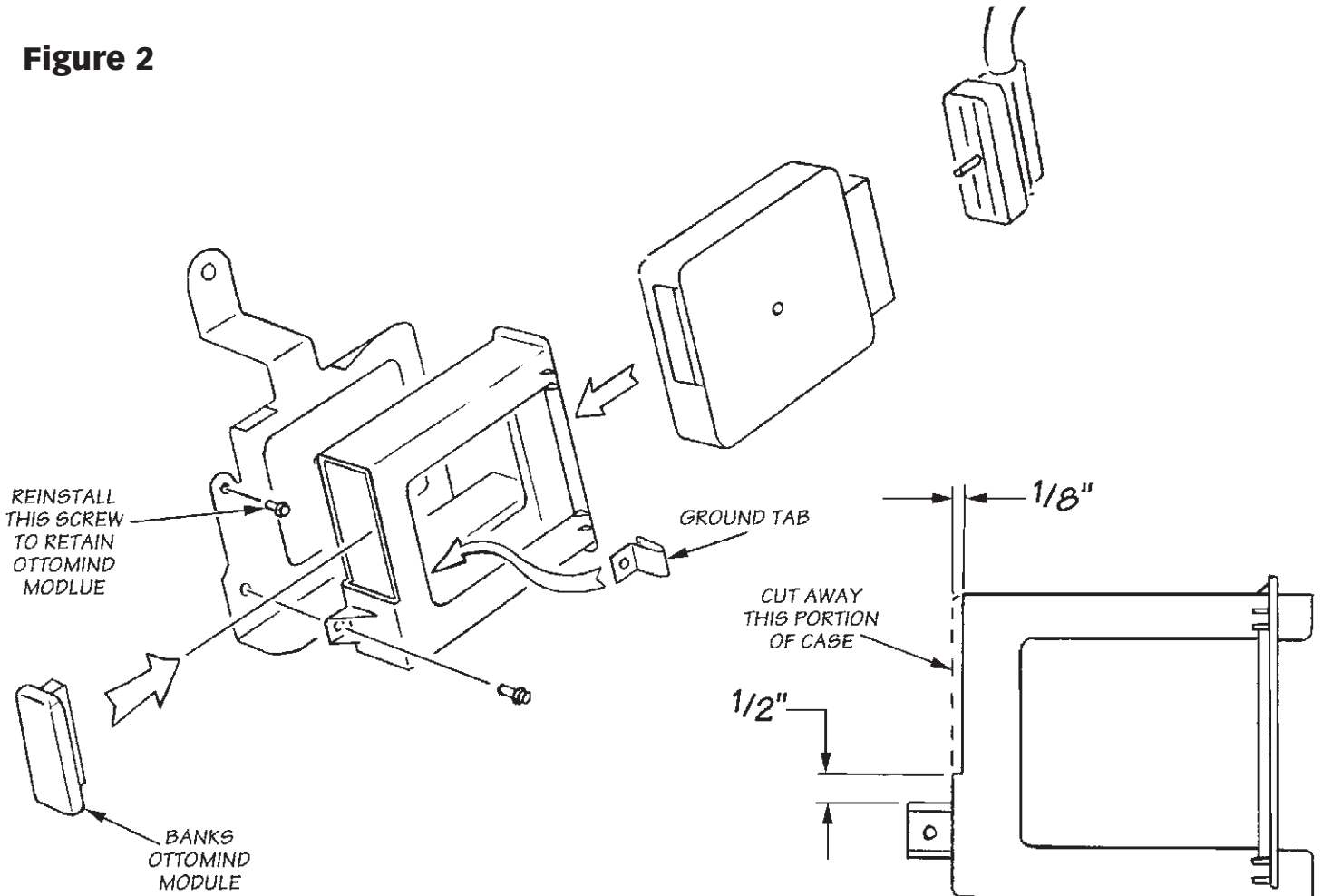

Figure 2



Gale Banks Engineering
546 Duggan Avenue • Azusa, CA 91702
(626) 969-9600 • Fax (626) 334-1743

Product Information & Sales: (800) 438-7693

bankspower.com