

banks

with Installation Instructions

Owner's Manual

Banks Ram-Air[®] Super-Scoop[®]

**2007-2008 Chevy/GMC 6.6L Duramax (LMM)
Turbo-Diesel Pickups**

THIS MANUAL IS FOR USE WITH KITS 42200

Gale Banks Engineering
546 Duggan Avenue • Azusa, CA 91702
(626) 969-9600 • Fax (626) 334-1743

Product Information & Sales: (888) 635-4565

bankspower.com

General Installation Practices

Dear Customer,

If you have any questions concerning the installation of your Banks Ram-Air Super Scoop, please call our Technical Service Hotline at (888) 839-2700 between 7:00 am and 5:00 pm (PT). If you have any questions relating to shipping or billing, please contact our Customer Service Department at (888) 839-5600.

Thank you.

1. For ease of installation of your Banks Ram-Air Super-Scoop, familiarize yourself with the procedure by reading the entire manual before starting work. This manual contains 24 pages of copy, illustrations and parts listing. If any pages are missing from this manual please call Gale Banks Engineering immediately for a replacement.
2. The exploded view of the Ram-Air Super-Scoop assembly (pages 4-5) provides only general guidance. Refer to each step and section diagram in this manual for proper instruction.
3. Throughout this manual, the left side of the vehicle refers to the driver's side, and the right-side to the passenger's side.
4. Disconnect the ground cable from the battery before beginning work. If there are two batteries, disconnect both.
5. Route and tie wires and hoses a minimum of 6 inches away from exhaust heat, moving parts and sharp edges. Clearance of 8 inches or more is recommended where possible.
6. During installation, keep the work area clean. If foreign debris

is transferred to any Banks system component, clean it thoroughly before installing.

7. When raising the vehicle, support it on properly weight-rated safety stands, ramps or a commercial hoist. Follow the manufacturer's safety precautions. Take care to balance the vehicle to prevent it from slipping or falling. When using ramps, be sure the front wheels are centered squarely on the topsides; put the transmission in park; set the parking brake; and place blocks behind the rear wheels.

CAUTION! DO NOT USE FLOOR JACKS TO SUPPORT THE VEHICLE WHILE WORKING UNDER IT. DO NOT RAISE THE VEHICLE ONTO CONCRETE BLOCKS, MASONRY OR ANY OTHER ITEM NOT INTENDED SPECIFICALLY FOR THIS USE.

WARNING: This product is intended for general highway use. Do not use this product when fording streams or crossing bodies of water. Although this product is designed to separate water from entering the engine during normal highway driving in rainy conditions, it is not intended to be submerged under water for any amount of time. Regularly check the inlet of the Super-Scoop for any obstruction or debris that may impede the flow of air. After the installation of the Super-Scoop be aware of the decreased ride height and drive accordingly to avoid damage to the Super-Scoop. Regularly check to make sure the Super-Scoop is fastened securely and that all hardware and fasteners are tight and in good condition.

Tools Required:

- 3/8" drive ratchets with metric sockets
- Standard and Phillips head screwdrivers
- Standard and needle-nose pliers
- Clean shop towels or rags
- Electric Drill
- Drill Bit: 1/8, 3/8, 1/4, 5/16

Table of Contents

Section 1 **4**
General Assembly

Section 2 **6**
Super-Scoop Installation

Section 1

GENERAL ASSEMBLY *Figure 1*

Item	Description	Part#	Qty
1	SUPER-SCOOP, RAM-AIR SYSTEM	42202	1
2	BRACKET, UPPER, SUPER-SCOOP	42204	1
3	BRACKET, LOWER, SUPER-SCOOP	42205	1
4	WASHER, USS, ZINC, 1/4	91103	4
5	NUT, NYLOCK, 1/4-20 UNC	91110	2
6	RETAINER, PUSH-TYPE, 20mm HEAD X 10mm DIA	92023	4
7	NUT, CLIP-ON, M6 X 1.0	91712	3
8	HEX BOLT, ZINC, 6mm X 1.0 X 25mm	91742	3
9	WASHER, SAE FLAT, ZINC, 1/4	91102	1
10	RETAINER, PUSH-TYPE, 11/16" HEAD X 1/4" DIA	92020	1

* Replace when nylon insert is worn and is no longer self-locking.

** Replace when nut is worn and is no longer self-locking.

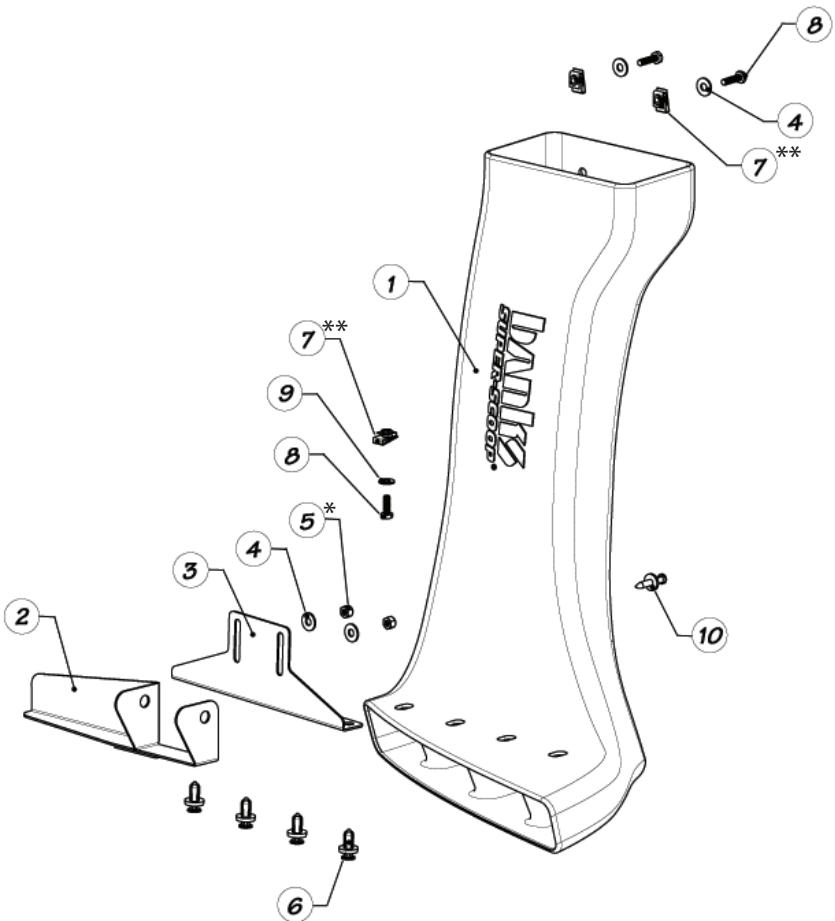

Section 2

SUPER-SCOOP INSTALLATION

NOTE: Before installing the Banks Super-Scoop make sure to have a completely installed Banks Ram-Air Intake System in your vehicle.

- 1.** Remove all plastic retainer pins attached to the fender lining, then remove the wheel liner and set aside. See **Figure 2**.
- 2.** Remove the wheel liner support bracket plastic retainers and detach the wire harness clip. See **Figure 3**.
- 3.** Use **Template 1** to place over the support bracket tab as shown in **Figure 4**. Center punch the marked hole on the template.
- 4.** Drill a pilot hole over the marked location with a $\frac{1}{8}$ " drill bit. Finish drilling with a $\frac{3}{8}$ " drill bit.
- 5.** Clean the hole and install a supplied Clip-On-Nut over the hole. Install the Clip-On-Nut so that the nut is position

facing up of the support bracket. See **Figure 5**.

- 6.** Loosely install the wheel liner support bracket and slide the bracket to the left so that the upper tab is in contact with the vehicle's frame member.
- 7.** Place **Template 1** over the bottom edge of the vehicle frame member as shown in **Figure 6**. Make sure that the edge of the support bracket is in contact with the vehicle frame member.
- 8.** Center punch the marked hole on the template. Remove the Support Bracket. Drill a pilot hole over the marked location with a $\frac{1}{8}$ " drill bit. Finish drilling with a $\frac{5}{16}$ " drill bit. See **Figure 7**.

Note: Only drill through the bottom of the vehicle's frame member.

Figure 2



Figure 3

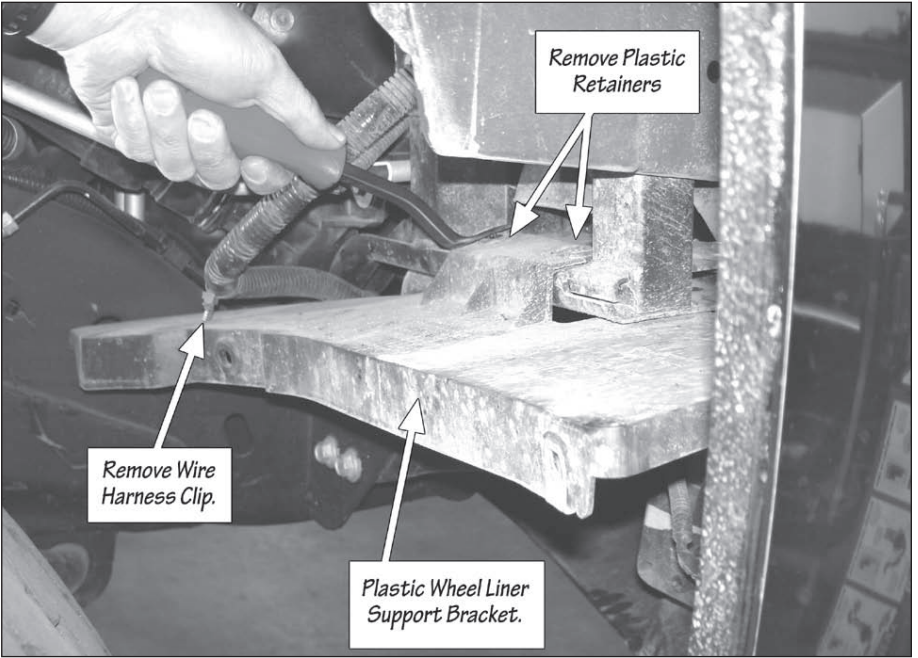

Figure 4



Figure 5

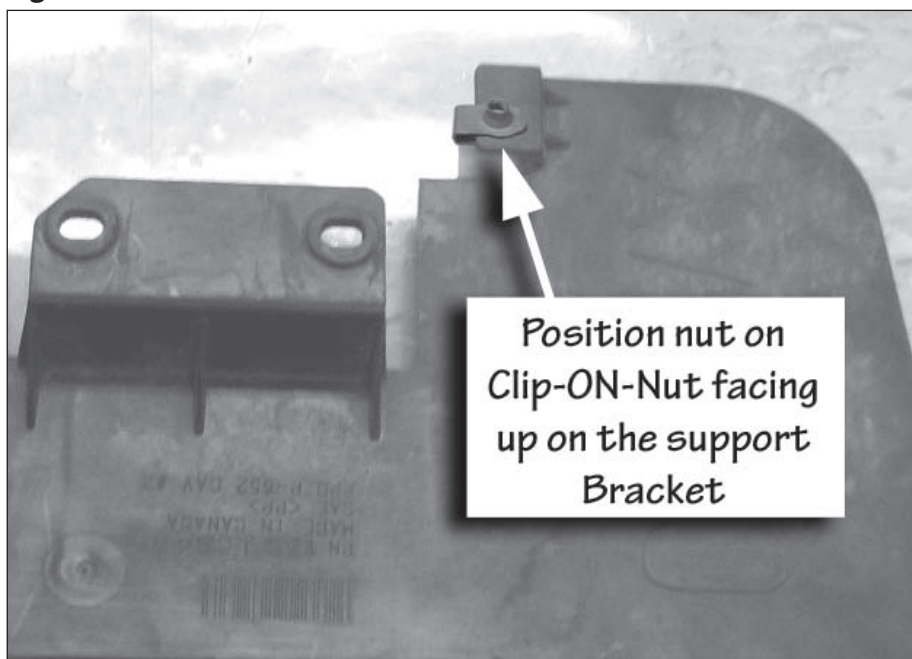

Figure 6

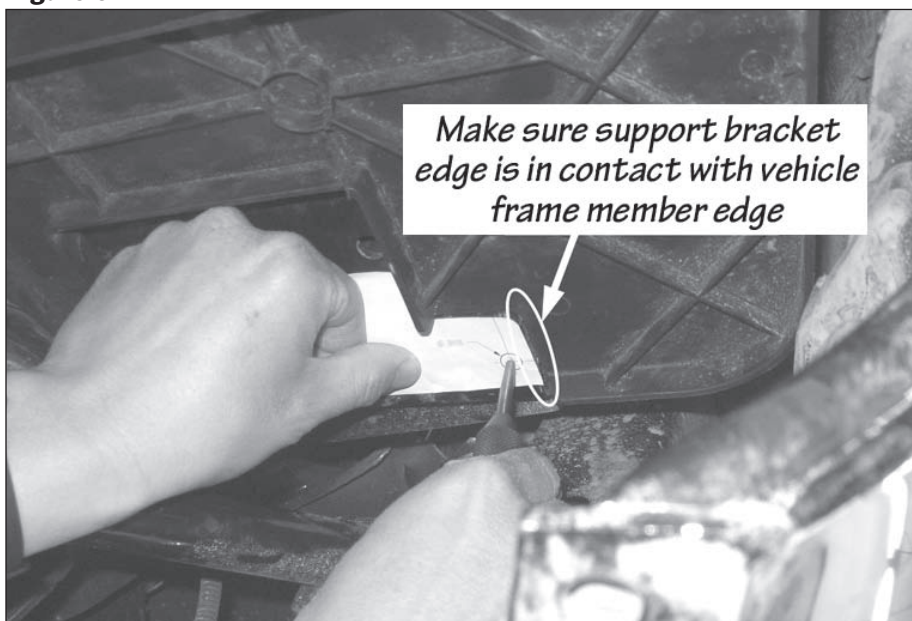

Figure 7

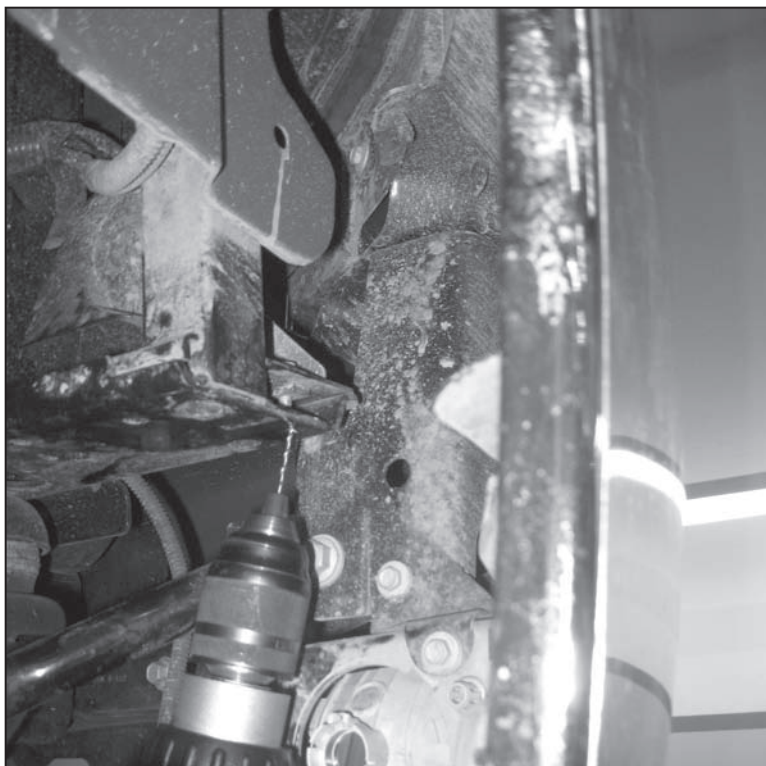

Figure 8

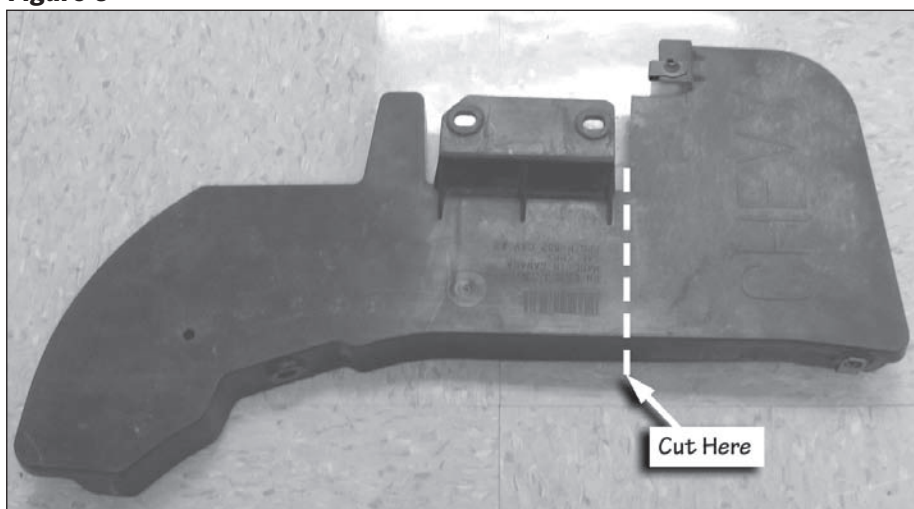

Figure 9

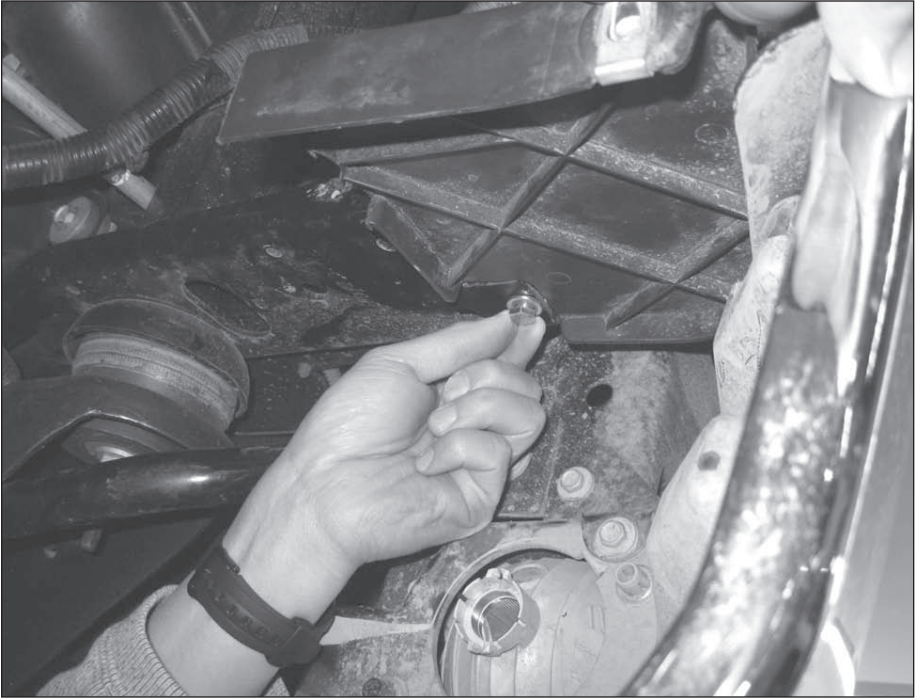

Figure 10

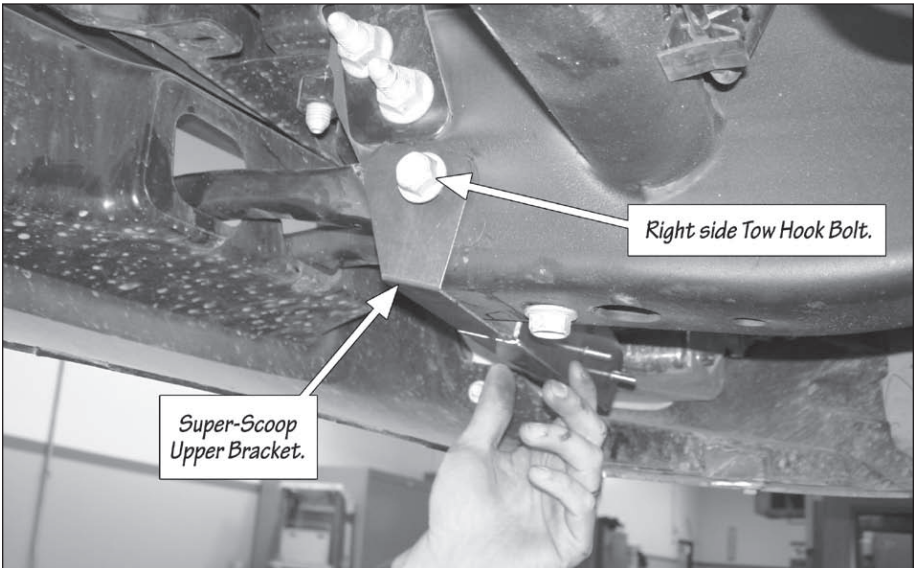
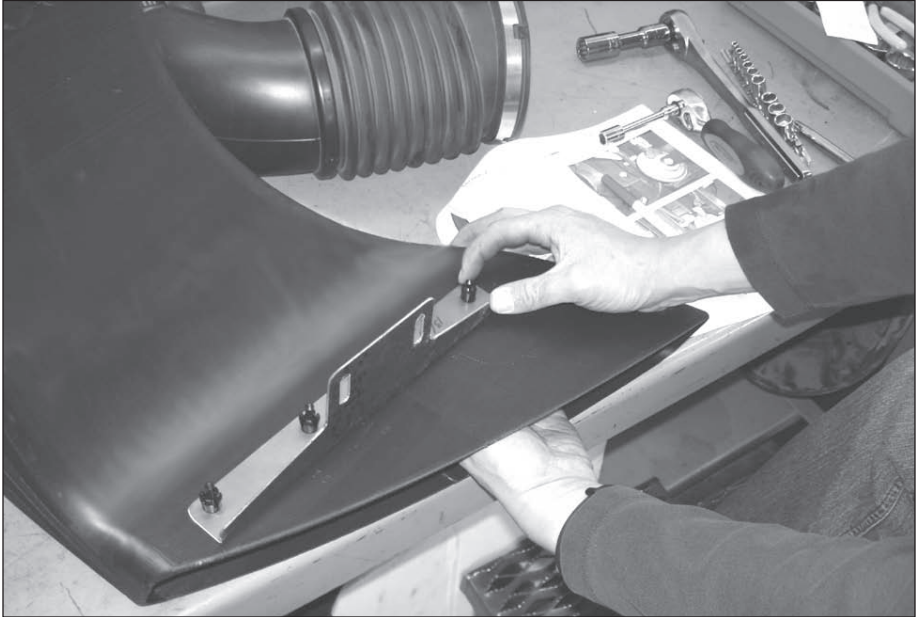

Figure 11



9. Cut the support bracket as shown in **Figure 8**.

10. Take the cut support bracket with the installed Clip-On-Nut and install into the vehicle's frame member. Use the supplied bolt and washer to fasten the support bracket to the vehicle's frame member. See **Figure 9**. Tighten the bolt till snug.

11. From under the vehicle remove the right side tow hook bolt to install the Super-Scoop upper bracket.

12. Locate the Super-Scoop Upper bracket and install over the tow hook using the previously removed bolt. See **Figure 10**. Hand tighten the bolt loosely at this time.

13. Locate the supplied Banks Super-Scoop, Lower bracket, and plastic push in retainers.

14. Position the support bracket over the slots on the Super-Scoop inlet

as shown in **Figure 11**. Secure the support bracket to the Super-Scoop using the supplied push in retainers from the inside of the Super-Scoop. Push in the center of the retainer to fasten the lower bracket to the Super-Scoop.

15. Remove the Banks Ram-Air Housing (reference Banks Ram-Air installation manual for removal). Place **Template 2** over the bottom edge of the housing on the side facing the passenger side tire. Center the template and center punch the marked holes on the template. See **Figure 12**.

16. Drill a pilot hole over the marked location with a $\frac{1}{8}$ " drill bit. Finish drilling with a $\frac{3}{8}$ " drill bit.

17. Clean the holes and install the supplied Clip-On-Nuts over the holes. Install the Clip-On-Nuts so that the nut is on the inside of the Ram-Air housing. See **Figure 13**.

Figure 12



18. Re-install the Ram-Air Housing following Banks Ram-Air installation manual.

19. Install the Banks Super-Scoop from beneath the front bumper and place the Super-Scoop's opening over the bottom of the Banks Ram-Air housing down spout. See **Figure 14**. Place the lower bracket slots over the threaded studs on the Upper bracket. Locate the supplied washer and nylock nuts and fasten the upper bracket to the lower bracket till snug. See **Figure 15**.

20. Install the supplied bolts and washers through the Super-Scoop holes attaching to the Clip-On-Nuts on the Ram-Air Housing, see **Figure 16**. Hand tighten the bolts.

Note: Clip-On-Nuts are self locking and will not allow the bolts to spin freely.

21. Now go to the inlet of the Super-Scoop and align the inlet to fit the contour of the spoiler. See **Figure 17 & Figure 18**.

22. Tighten the nylock nuts that fasten the Upper Bracket to the Lower Bracket. Do not reuse nylock nuts if the nylon insert is worn and is no longer self-locking.

23. Go back to the fender well and tighten the bolts to the Clip-On-Nuts. Do not reuse the clip-on-nuts if the nut is worn and is no longer self-locking.

24. Tighten the right side tow hook bolt to 52 ft-lbs and securely fasten the Upper Bracket to the vehicle frame. See **Figure 10**. Access the tow hook bolt from the tow hook opening see **Figure 19**.

Figure 13

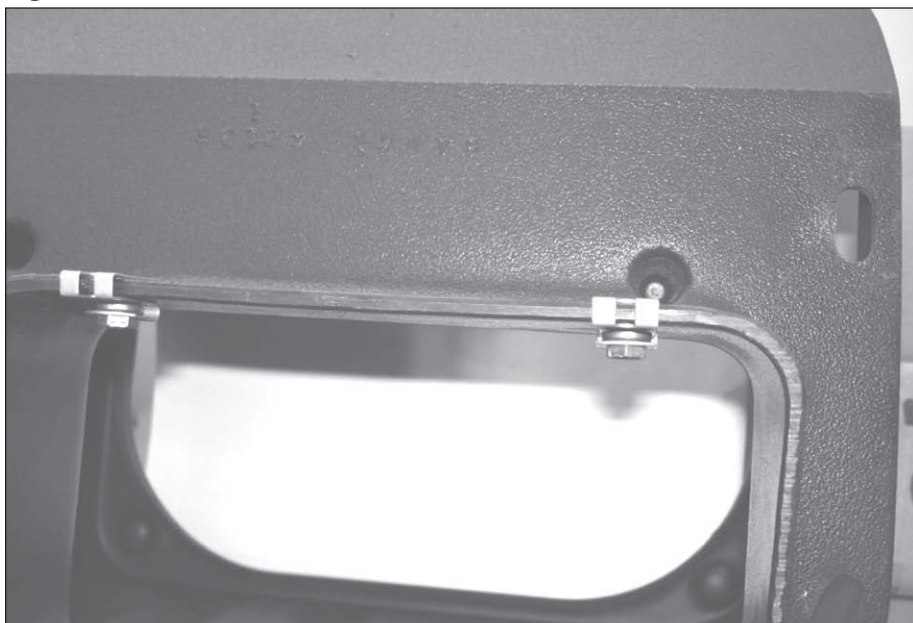

Figure 14



Figure 15

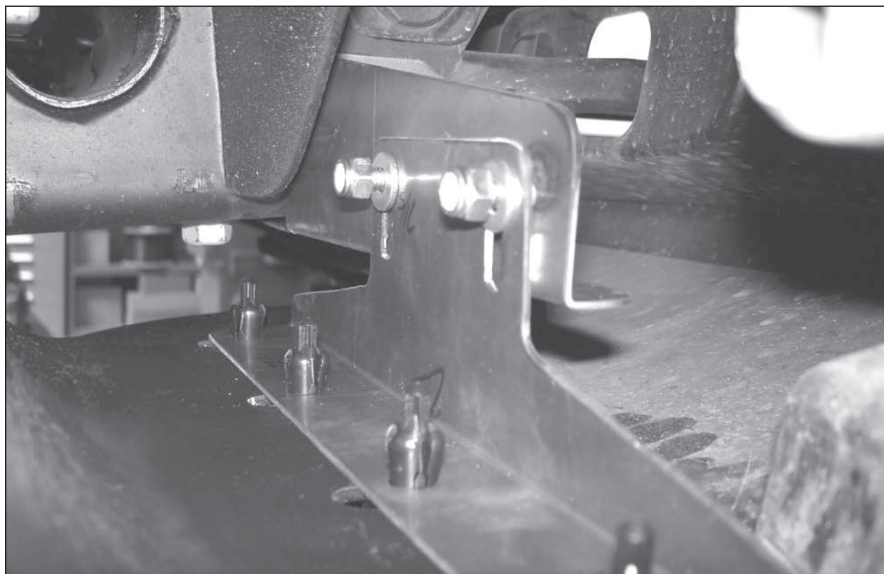

Figure 16

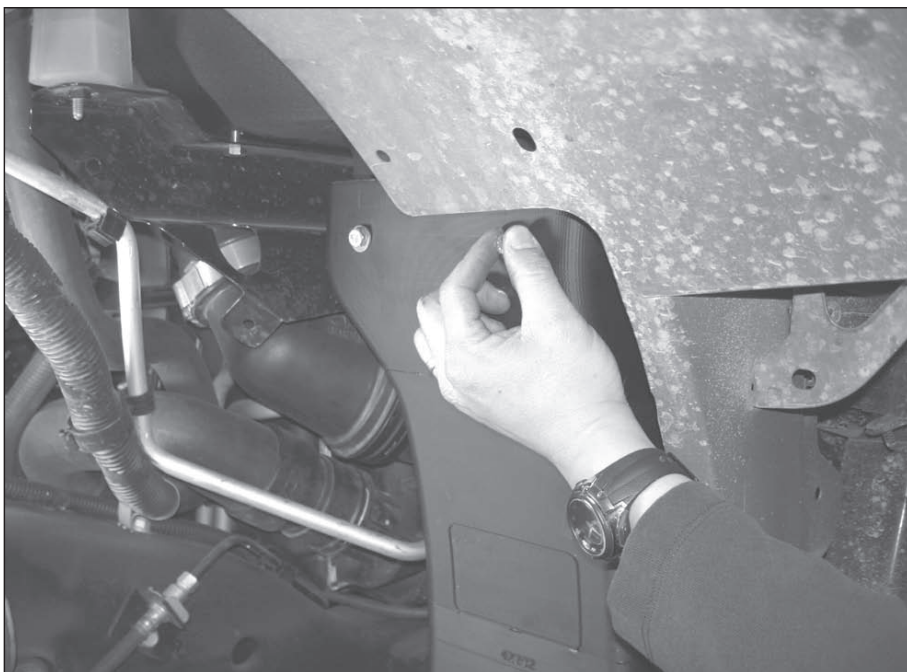

Figure 17



Figure 18

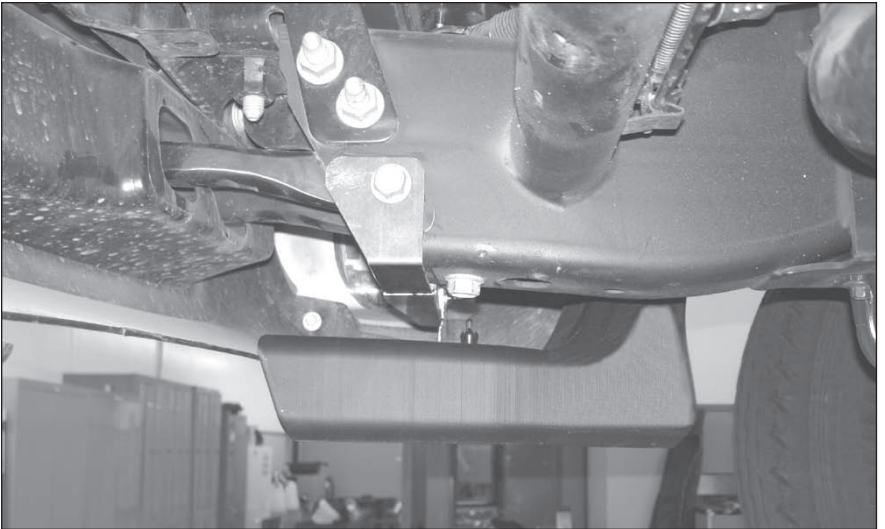
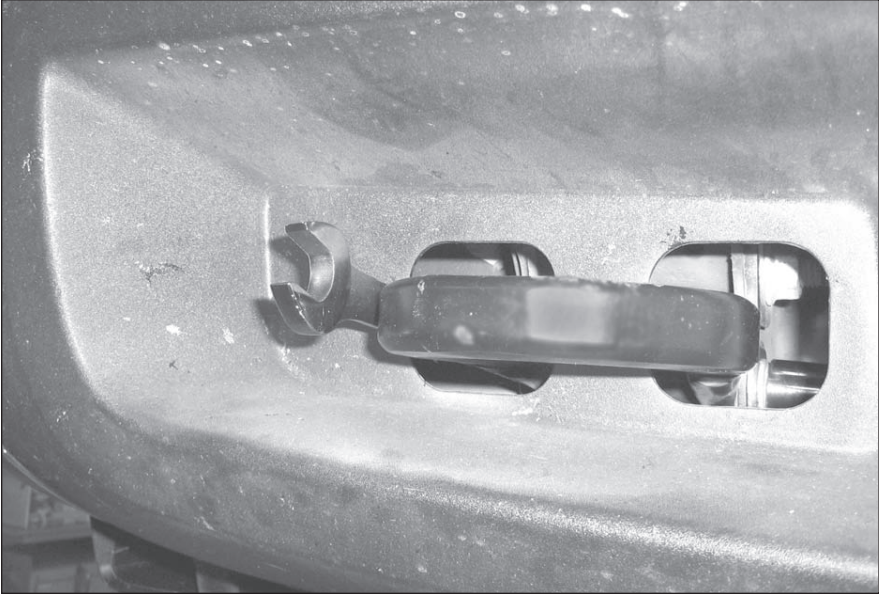

Figure 19 To Access The Tow Hook Bolt



25. Make sure that the Super-Scoop is in a position that does not interfere with the chassis frame, bumper support, wire harnesses, wheel well liner, or any other components.

WARNING: If the Super Scoop is not positioned properly it will interfere with the wheel or wheel well liner. Make sure there is adequate clearance between the Super-Scoop and wheel at all extreme positions of the wheel. (Full steering and suspension travel).

26. Position the fender well liner into the wheel well. Attach the previously removed wire harness to the fender well liner. Install the fender well liner and secure it using the previously removed plastic retaining pins.

Note: when installing the fastener to the cut Wheel liner support bracket make sure that it is fasten to the support bracket.

27. Take a measuring tape and place over the hole on the inside of the wheel liner to the fastener over the support bracket as shown in **Figure 20**. Measure 4" from the inside and mark that location.

28. Center punch the marked location and drill a pilot hole through the liner and into the Banks Super-Scoop with a 1/8" drill bit. Finish drilling with a 1/4" drill bit.

29. Locate a supplied push in retainer and insert into the drilled hole. Push in the center of the retainer to fasten it. See **Figure 21**.

Note: make sure to fasten the liner to the Banks Super-Scoop.

30. You have now successfully installed the Banks Super-Scoop to your vehicle.

Figure 20

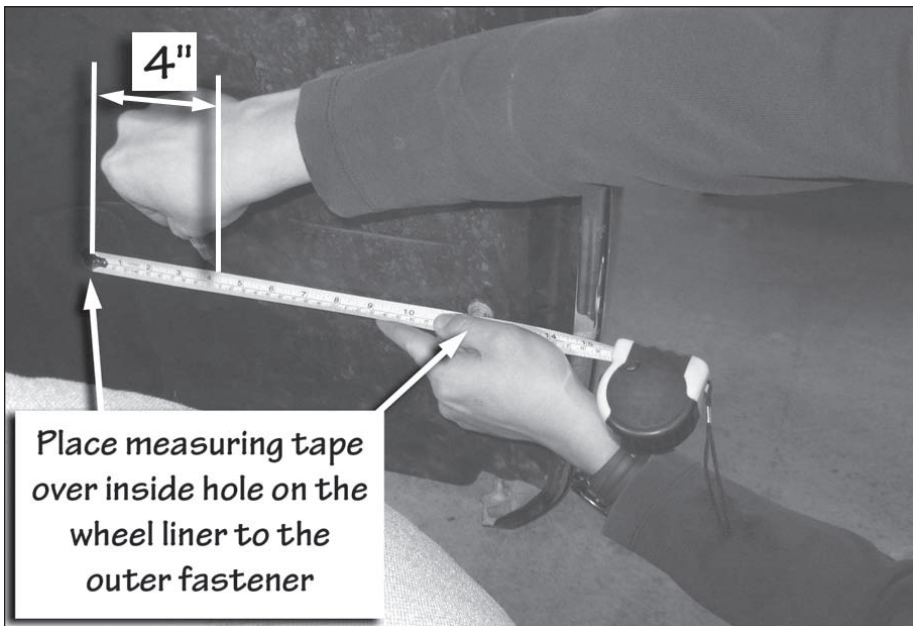
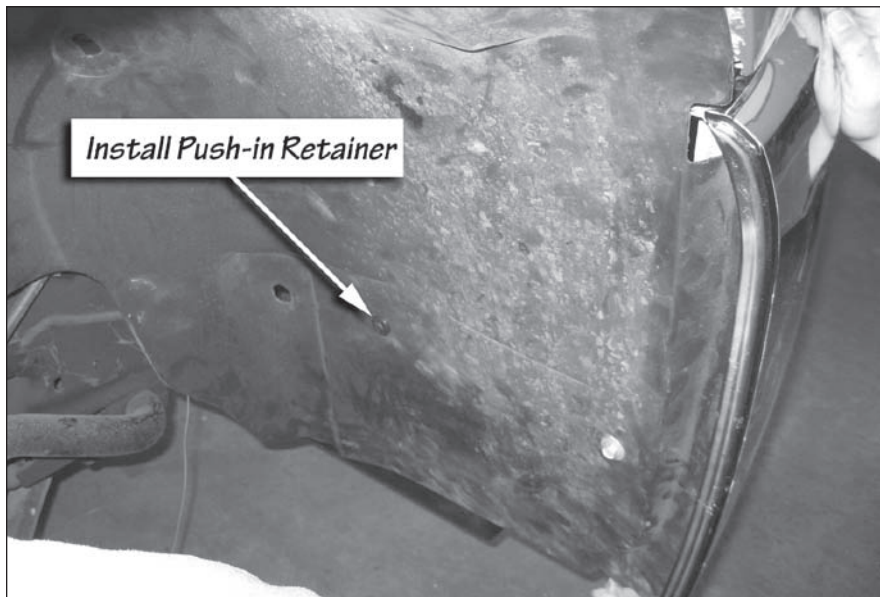
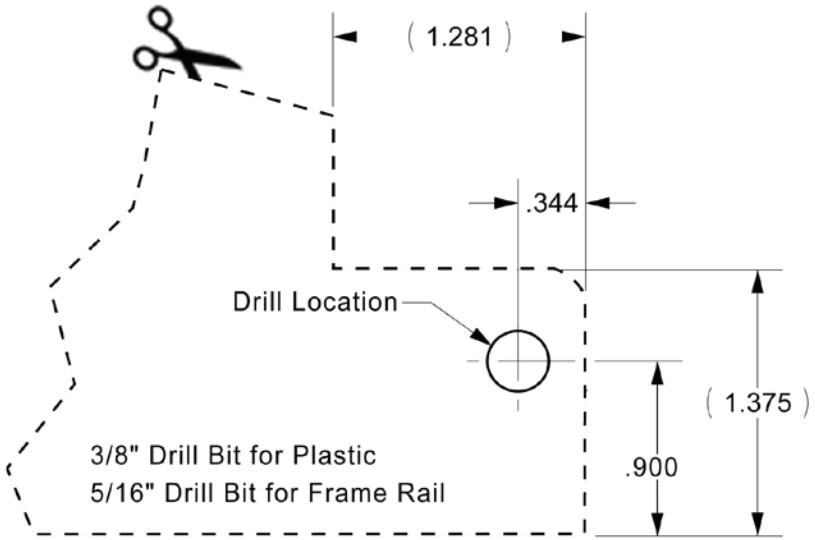

Figure 21



Template 1 Wheel Liner Support Bracket Drill Template



This Page Intentionally Left Blank

Template 2
Ram-Air Box
Drill Template

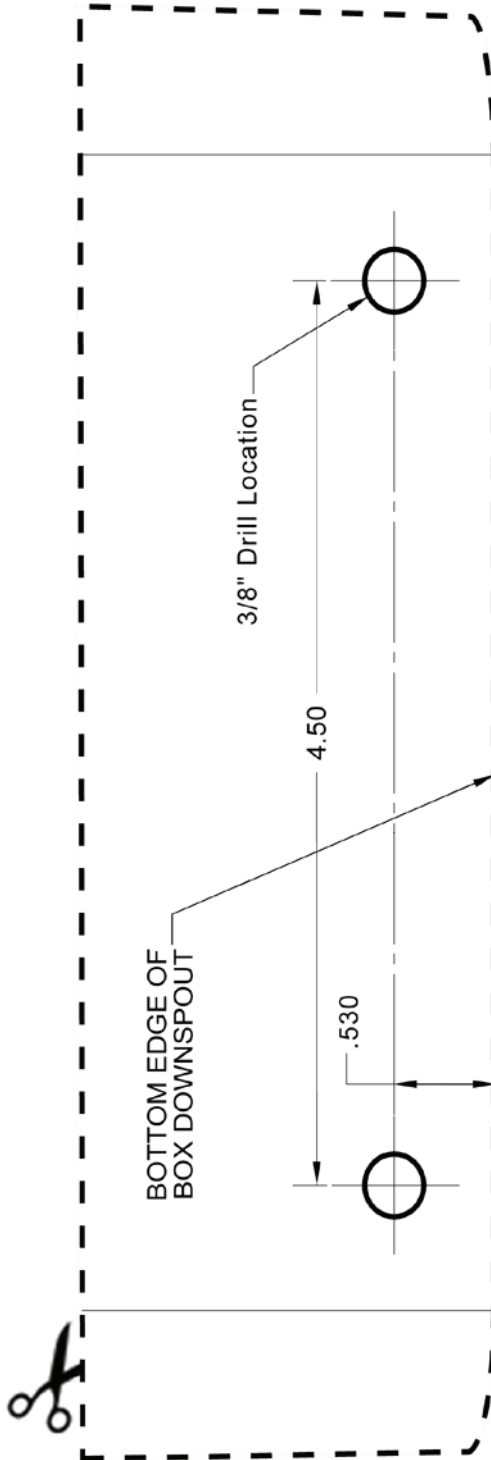

Gale Banks Engineering
546 Duggan Avenue • Azusa, CA 91702
(626) 969-9600 • Fax (626) 334-1743

Product Information & Sales: (888) 635-4565

bankspower.com